

SAFETY FIRST!
Always wear Safety Glasses and applicable Personal Protective Equipment during installation

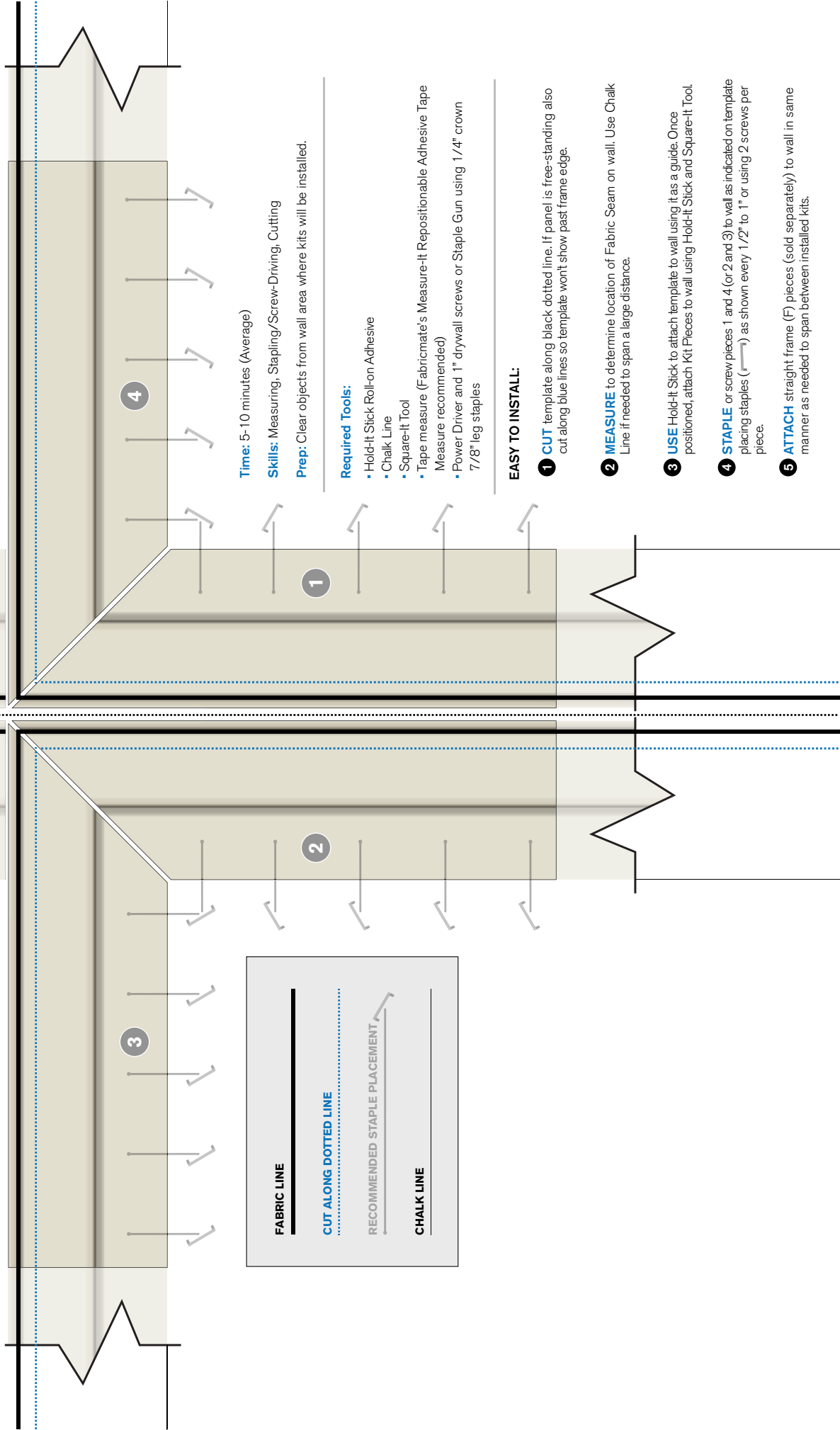

Time: 5- 10 minutes (Average)

Skills: Measuring, Stapling/Screw-Driving, Cutting

Prep: Clear objects from wall area where kits will be installed.

Required Tools:

- Hold-It Stick Roll-on Adhesive
- Chalk Line
- Square-It Tool
- Tape measure (Fabricmate's Measure-It Repositionable Adhesive Tape Measure recommended)
- Power Driver and 1" drywall screws or Staple Gun using 1/4" crown 7/8" leg staples

EASY TO INSTALL:

- CUT** template along black dotted line. If panel is free-standing also cut along blue lines so template won't show past frame edge.
- MEASURE** to determine location of Fabric Seam on wall. Use Chalk Line if needed to span a large distance.
- USE** Hold-It Stick to attach template to wall using it as a guide. Once positioned, attach Kit Pieces to wall using Hold-It Stick and Square-It Tool.
- STAPLE** or screw pieces 1 and 4 (or 2 and 3) to wall as indicated on template placing staples (→) as shown every 1/2" to 1" or using 2 screws per piece.
- ATTACH** straight frame (F) pieces (sold separately) to wall in same manner as needed to span between installed kits.