

INSTALLATION INSTRUCTIONS

Single-pin Impaling Clips mount to most surfaces. Available with self-adhesive or perforated variations (to be used with mounting adhesive or screws – sold separately). Compatible with 1/4", 1/2", 1", & 2" semi-rigid insulation.

PERSONAL SAFETY IS ALWAYS THE FIRST STEP IN ANY INSTALLATION PROCEDURE. WORK SAFELY, OBTAIN ASSISTANCE AS NEEDED, AND ALWAYS WEAR SAFETY GLASSES AND PROPER PERSONAL PROTECTIVE EQUIPMENT. THUMB TACKS ARE SHARP. USE CAUTION TO AVOID CUTS AND PUNCTURES AND KEEP AWAY FROM CHILDREN. MAGNETS CAN INTERFERE WITH PACEMAKERS AND OTHER MEDICAL DEVICES. KEEP MAGNETS FAR AWAY FROM MEDICAL DEVICES TO AVOID INTERFERENCE.

- Anchor must be applied to a clean, dry, non-painted surface
- Press anchor on with twisting motion to ensure an even spread
- Allow adhesive to dry thoroughly before hanging insulation
- Bend the nail if unable to cut it

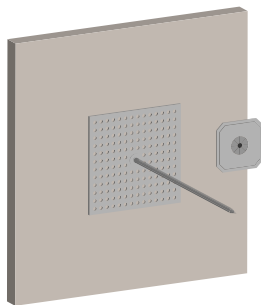

Adhere base to surface with general purpose adhesive or screws

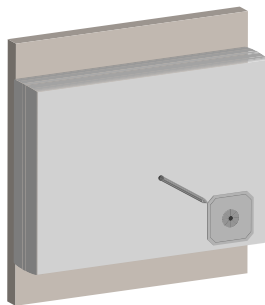

Carefully impale the substrate and add the retaining washer

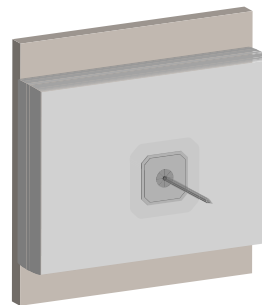

Press the retaining washer onto the substrate so it's holding snug

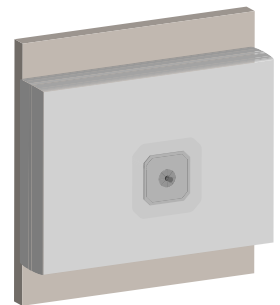

Cut off the remaining pin as close to the retaining washer as possible

We have a couple of layouts we recommend for the location of Impaling Pins which are outlined below. Examples are showing 4'x8' ReCore®. Keep impaling pins about 1' from the edges/corners.

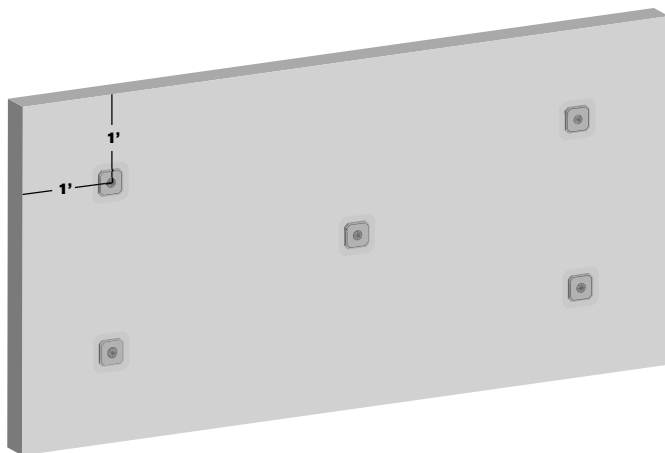

Impaling Pin Layout Option 1
(Example shows 4'x8' ReCore®)

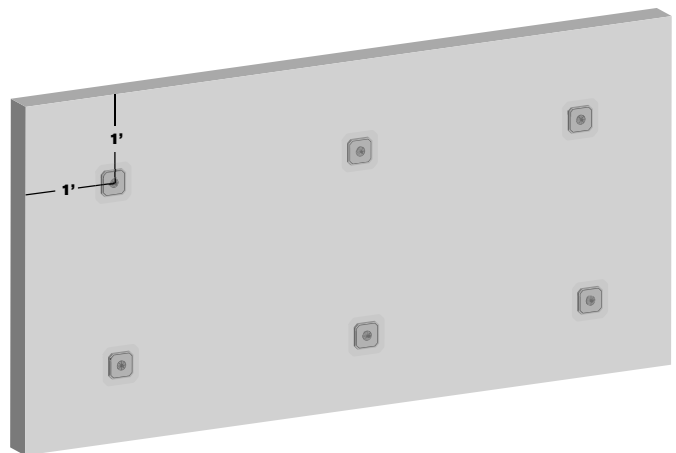

Impaling Pin Layout Option 2
(Example shows 4'x8' ReCore®)